

For information about other American International automotive accessories visit our website at:

<http://www.aius.net>

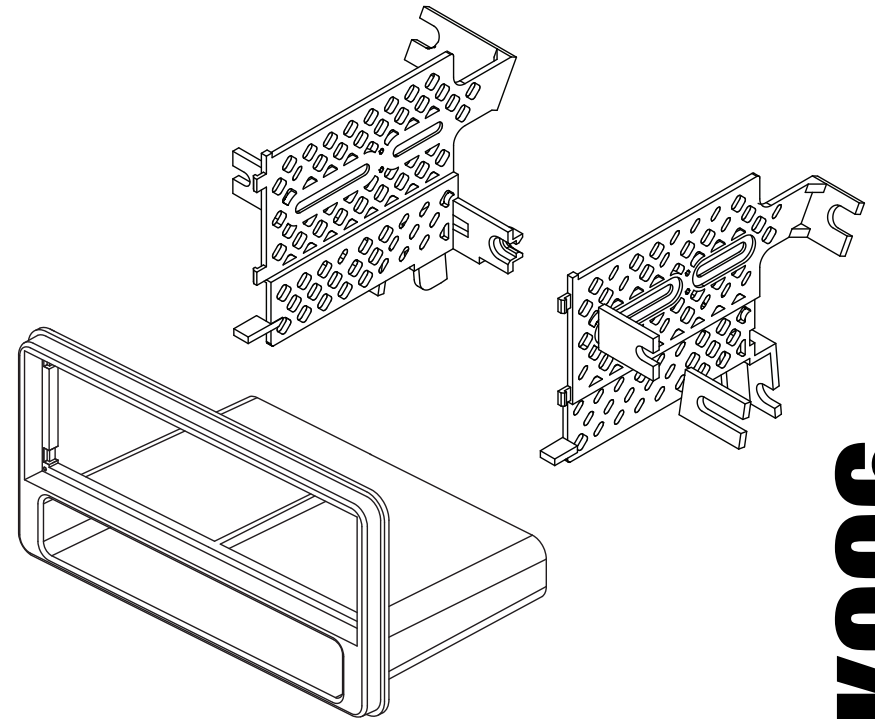

**American
International**
Car Stereo Installation Kits & Accessories



TOYK996 Mounting Kit



American International

2500 East Francis Street Ontario, CA 91761, U.S.A.

USA Sales (800) 336-6500

Canada Sales (888) 922-3006 • USA Fax (805) 388-7950

VEHICLE APPLICATIONS

Scion

2013-15 FRS

2012-15 IQ

Subaru

2013-15 BRZ

CUSTOMER HELP LINE

USA 800-323-4329 • Canada 800-245-8777

iTOYK996

©2015 AMERICAN INTERNATIONAL INDUSTRIES, INC.

TECH Ver. 1/15 PRINT Ver. 1/15

DIN MOUNT INSTRUCTIONS

1. Attach ISO mount brackets to rear of kit as shown in illustration B and attach to rear of pocket using small screws provided with kit.
2. Insert DIN sleeve from your new radio into the upper section of the installation kit (See Fig A below).
3. Depress the tabs from inside the sleeves opening upward, outward, and downward to secure sleeve to the installation kit.
4. Install radio into sleeve and lock into place.
5. SUGGESTED...Support rear of radio with back strap.

Fig A

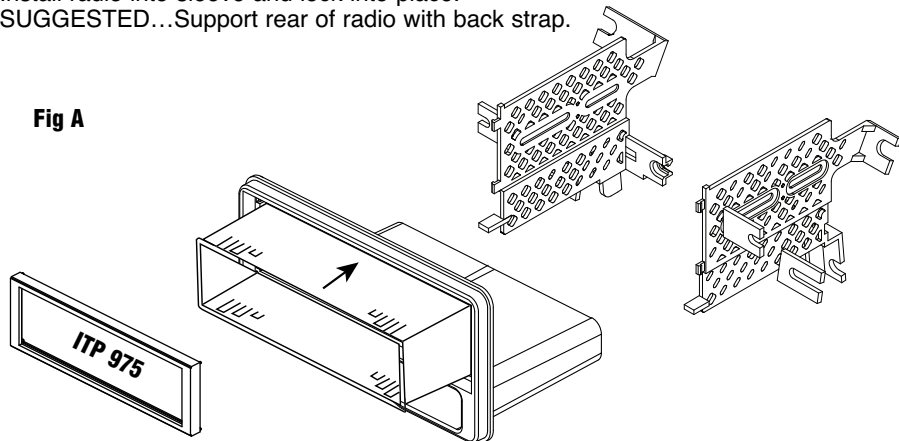

ISO MOUNT INSTALLATION INSTRUCTIONS

Note: Some radio faces are larger in size than the ITP975 Trim Ring allows. You may need to file the opening larger for some radios.

1. Attach ISO mount brackets to rear of kit as shown illustration B and attach to rear of pocket using small screws provided with kit, and insert spacers into both brackets.
2. Insert ISO mountable radio between ISO mount brackets and loosely attach to sides of radio using screws provided with radio when possible or large wafer head screws supplied with kit. (Be sure the length of the screws DO NOT touch any electrical parts inside radio, some screws may need to be shortened.)
3. Attach ISO trim ring to face of kit.
4. Slide radio forward or backward for desired look and tighten screws.

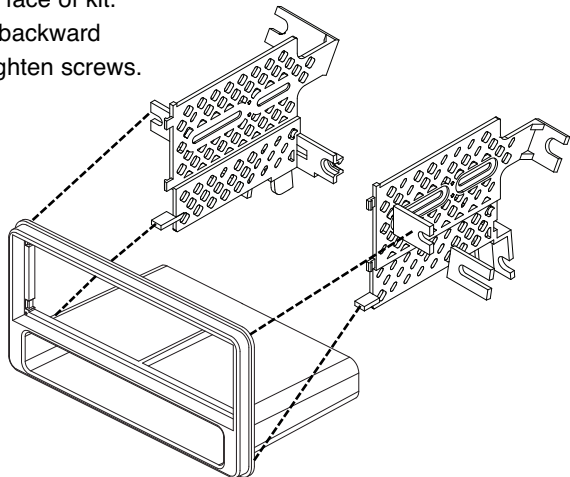

SCION IQ

DASH DISASSEMBLY

1. Carefully unclip and remove the panel with ac vents from around the hazard button. Unplug hazard button.
2. Carefully unclip and pry forward the radio trim housing. Do not unplug Airbag light.
3. Place the housing on the dash (you can use something to protect the dash) while installing new radio.
5. Remove the (4) 10mm bolts securing the radio to the sub-dash.
6. Pull radio forward, disconnect the attached wire harness and antenna lead and remove radio.

BRZ/FRS

DASH DISASSEMBLY

1. Carefully unclip and remove the panel surrounding the radio.
2. Remove the (4) 10mm bolts securing the radio to the sub-dash.
3. Pull radio forward, disconnect the attached wire harness and antenna lead and remove radio.

KIT ASSEMBLY

FOR ISO or DIN MOUNT APPLICATIONS.

IQ

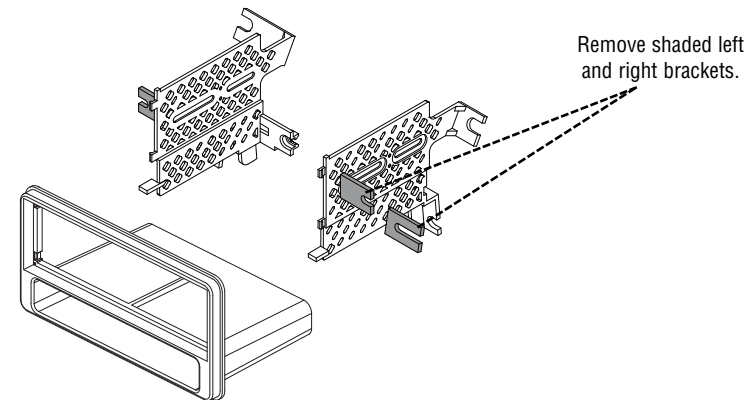

BRZ/FRS

